

Contents

Moulding

161 Moulding	N-6	Crown Extension Pate	N-5
62781T Moulding	N-6	Dentil Moulding	N-8
Base Moulding	N-6	DF-2 Moulding	N-8
Base Shoe	N-7	Egg & Dart Moulding	N-9
Batten Moulding	N-7	Flute Moulding	N-9
Bead (10662) Moulding	N-7	Light Rail Moulding	N-9
Beaded (Solid Wood)	N-7	Outside Corner Moulding	N-9
Bead Moulding	N-7	Panel Moulding	N-9
Bullname Moulding	N-7	Portsmouth Moulding	N-9
Casing Moulding	N-8	Rope Moulding	N-10
Chair Rail Moulding	N-8	Scribe Moulding	N-10
Countertop Edge	N-13	Spindle Moulding	N-14
Cove Moulding	N-3	Spindle Rail Moulding	N-10
Cover Moulding	N-8	Tear Drop Moulding	N-10
Crown Moulding	N-2	Toekick	N-10
Crown Moulding	N-3	Trim Moulding	N-11
Crown Moulding	N-4	Under Cabinet Moulding	N-13
Crown Moulding	N-5	Vermont Moulding	N-11
Crown Mounting Plate (384)	N-5	Youngstown Moulding	N-11
Crown Plate	N-5		

End Blocks	N-14
Foot	N-11
Keystone	N-13
Rosettes	N-11

Other

Spindles	N-15
Square Post	N-15
Stock (Decorative)	N-6
Stock (Decorative Solid)	N-6

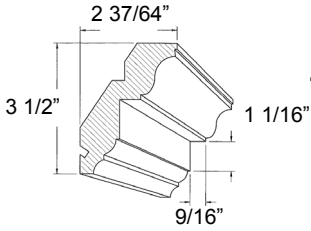

#342 Crown

Available red oak, maple, cherry, and clear alder. 3/4" rope.
7/8" Dentil, or 1" Egg & Dart moulding can be used on this crown.

C342-MLD-8 \$454

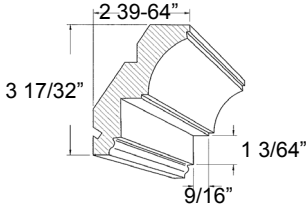

#343 Crown

Available red oak, maple, cherry, and clear alder. 3/4" rope.
7/8" Dentil, or 1" Egg & Dart moulding can be used on this crown.

C343-MLD-8 \$454

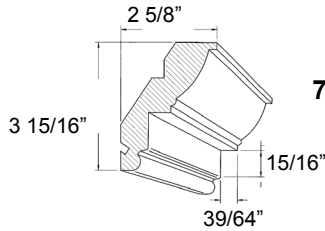

#344 Crown

Available red oak, maple, cherry, and clear alder. 3/4" rope.
7/8" Dentil, or 1" Egg & Dart moulding can be used on this crown.

C344-MLD-8 \$454

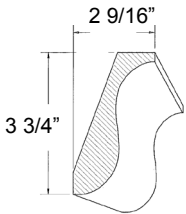

#1017 Crown

C1017-MLD-8 \$452

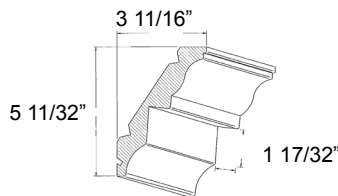

#1621 Crown

Available red oak, maple, cherry, and clear alder.
1 1/2" rope. 1 1/2" Dentil, or 1 1/2" Egg & Dart moulding can be used on this crown.

C1621-MLD-8 \$912

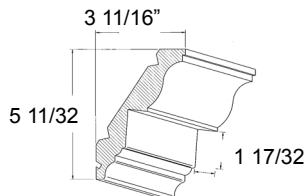

#1622 Crown

Available red oak, maple, cherry, and clear alder.
1 1/2" rope. 1 1/2" Dentil, or 1 1/2" Egg & Dart moulding can be used on this crown.

C1622-MLD-8 \$912

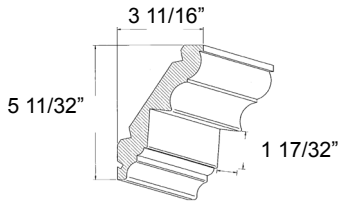

#1623 Crown

Available red oak, maple, cherry, and clear alder.
1 1/2" rope. 1 1/2" Dentil, or 1 1/2" Egg & Dart moulding can be used on this crown.

C1623-MLD-8	\$912
-------------	-------

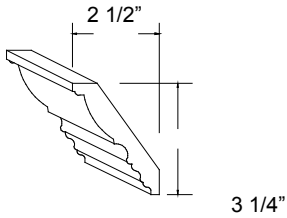

#30351 Crown

C30351-4	\$241
C30351-8	\$370

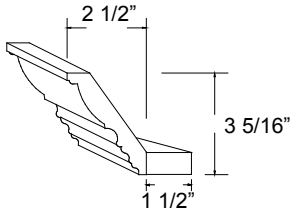

FAC30351-4	\$267
FAC30351-8	\$423

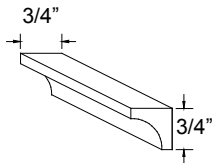

Cove Moulding

CV-MLD-4	\$50
CV-MLD-8	\$78
CV-MLD-10	\$107

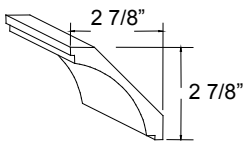

P-1440 Extra Large Cove

P-1440-4	\$241
P-1440-8	\$370
P-1440-10	\$509

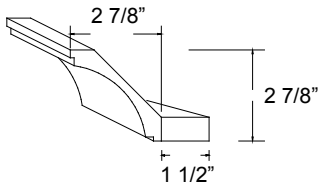

FALP-1440-4	\$267
FALP-1440-8	\$423
FALP-1440-10	\$575

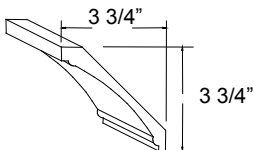

P-1460 Extra Large Cove

Not available in knotty alder, red birch, quarter sawn oak, or mahogany

P-1460-4	\$264
P-1460-8	\$407
P-1460-10	\$560

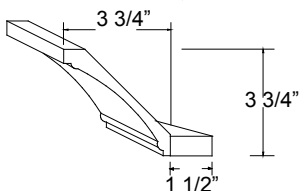

FAP-1460-4	\$291
FAP-1460-8	\$460
FAP-1460-10	\$627

Large Crown Moulding

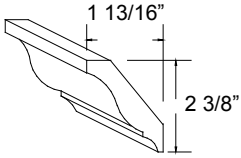

LC-MLD-4	\$156
LC-MLD-8	\$241
SC-MLD-10	\$332

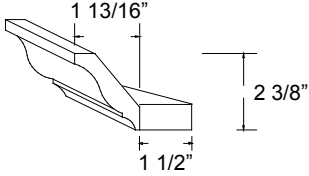

FALC-MLD-4	\$148
FALC-MLD-8	\$294
FALC-MLD-10	\$398

WM-46 Extra Large Crown

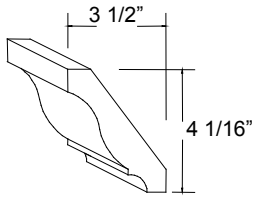

WM-46-4	\$264
WM-46-8	\$407
WM-46-10	\$560

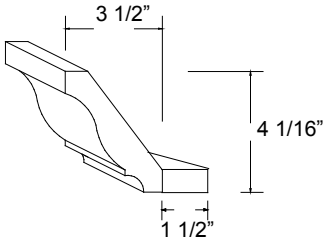

FAWM-46-4	\$291
FAWM-46-8	\$460
FAWN-46-10	\$627

WM-48 Extra Large Crown

Knotty alder not available in 10' lengths

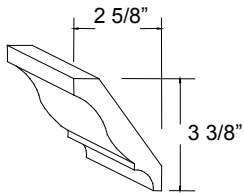

WM-48-4	\$241
WM-48-8	\$370
WM-48-10	\$509

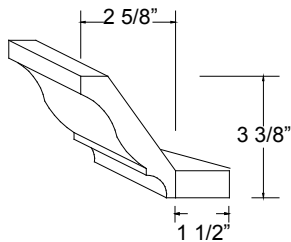

FAWM-48-4	\$212
FAWM-48-8	\$423
FAWM-48-10	\$575

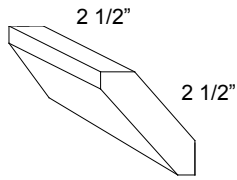

Shaker Crown

SHKC-MLD-4	\$156
SHKC-MLD-8	\$241
SHKC-MLD-10	\$332

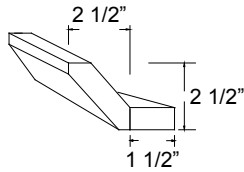

FASHKC-MLD-4	\$148
FASHKC-MLD-8	\$294
FASHKC-MLD-10	\$398

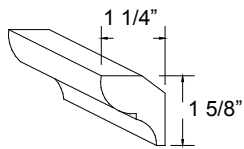

Small Crown Moulding

SC-MLD-4	\$111
SC-MLD-8	\$171
SC-MLD-10	\$235

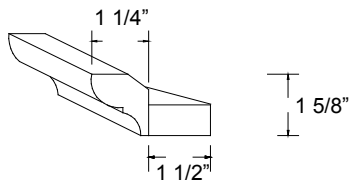

FASC-MLD-4	\$114
FASC-MLD-8	\$223
FASC-MLD-10	\$301

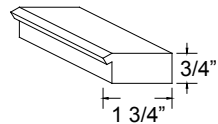

#384 Crown Mounting Plate

Available in red oak, cherry, and maple only

#384 crown mounting plate can be used to mount #342, #343, and #344 to cabinets.

CMP384-MLD-8	\$132
--------------	-------

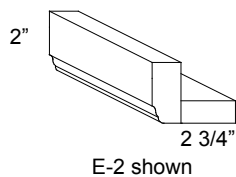

Crown Extension Bracket

Specify nosing detail, see section M for choices

CREXBR-4	\$82
CREXBR-8	\$125
CREXBR-10	\$173

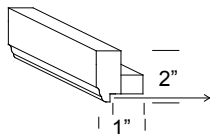

Crown Plate

Specify nosing detail, see section M for choices

CROWNPL-4	\$82
CROWNPL-8	\$125
CROWNPL-10	\$173

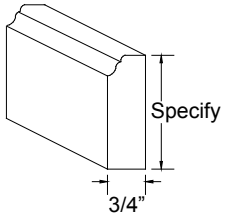

Decorative Solid Stock

DEC-STOCK

See section M, Solid Stock

Decorative Stock

6 foot lengths. Maple only.

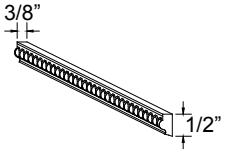

0818-MLD-6

\$56

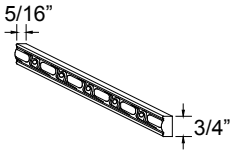

0789-MLD-6

\$60

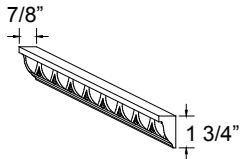

1079-MLD-6

\$111

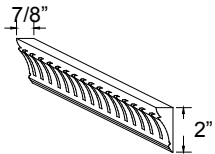

1050-MLD-6

\$130

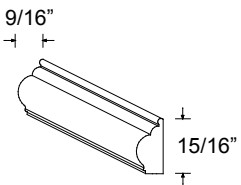

161 Moulding

161-MLD-4

\$71

161-MLD-8

\$110

161-MLD-10

\$151

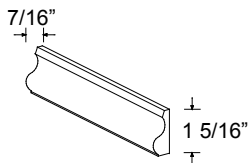

#62781T Moulding

62781T-MLD-4

\$104

62781T-MLD-8

\$161

62781T-MLD-10

\$222

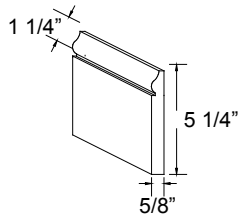

Base Moulding

B-MLD-4

\$198

B-MLD-8

\$305

B-MLD-10

420

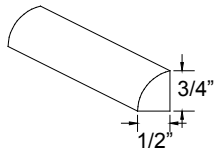

Base Shoe Moulding

BS-MLD-4	\$50
BS-MLD-8	\$78
BS-MLD-10	\$107

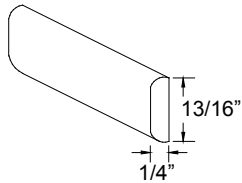

Batten Moulding

BM-MLD-4	\$50
BM-MLD-8	\$78
BM-MLD-10	\$107

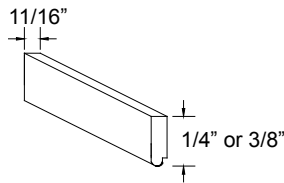

Bead Moulding

1/4" BEAD-MLD-4	\$48
1/4" BEAD-MLD-8	\$73
1/4" BEAD-MLD-10	\$101
3/8" BEAD-MLD-4	\$48
3/8" BEAD-MLD-8	\$73
3/8" BEAD-MLD-10	\$101

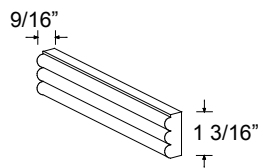

#10662 Bead Moulding

10662 BEAD-MLD-4	\$104
10662 BEAD-MLD-8	\$161
10662 BEAD-MLD-10	\$224

Solid Wood Beaded Moulding

3/8" thick X 3 1/4" wide solid wood beaded strips (3" wide when finished) available in 4' or 8' lengths. G022 beading spaced 1 1/2" on side "A", and 3" on side "B". Must specify which side is exposed.

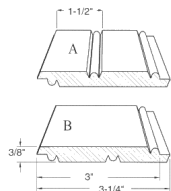

BEAD-PNL-A-4	\$102
BEAD-PNL-B-4	\$102
BEAD-PNL-A-8	\$203
BEAD-PNL-B-8	\$203

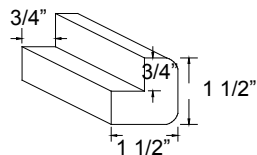

Bullnose Moulding

BN-MLD-4	\$125
BN-MLD-8	\$193
BN-MLD-10	\$264

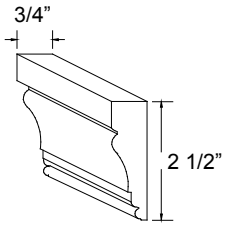

Casing Moulding

C-MLD-4	\$118
C-MLD-8	\$181
C-MLD-10	\$250

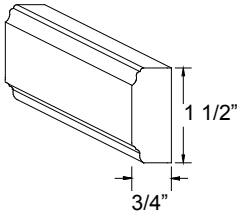

Chair Rail Moulding

CHR-MLD-4	\$111
CHR-MLD-8	\$171
CHR-MLD-10	\$235

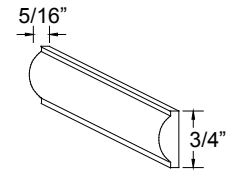

Cover Moulding

COVER-MLD-4	\$73
COVER-MLD-8	\$111
COVER-MLD-10	\$149

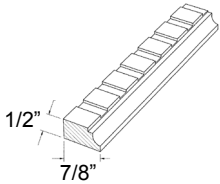

7/8" Dentil Moulding

Available in red oak, cherry, and maple only

7/8" DT-MLD-8	\$204
---------------	-------

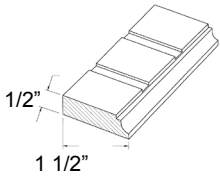

1 1/2" Dentil Moulding

Available in red oak, cherry, and maple only

1 1/2" DT-MLD-8	\$294
-----------------	-------

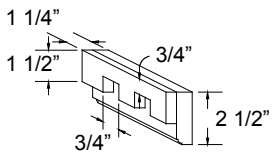

2 1/2" Dentil Moulding

2 1/2" DT-MLD-8	\$481
-----------------	-------

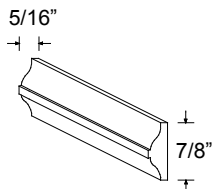

DF-2 Moulding

DF-2-MLD-4	\$71
DF-2-MLD-8	\$110
DF-2-MLD-10	\$151

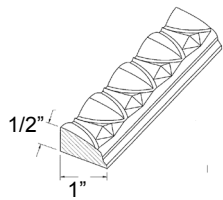

Egg & Dart Moulding

Available in red oak, cherry, and maple only

ED-MLD-8 \$635

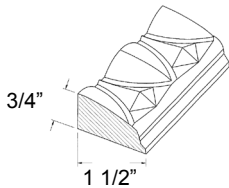

1 1/2" Egg & Dart Moulding

Available in red oak, cherry, and maple only

1 1/2" ED-MLD-8 \$774

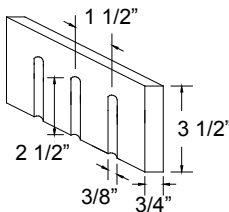

Flute Moulding

FLUTE-MLD-8 \$337
FLUTE-MLD-10 \$463

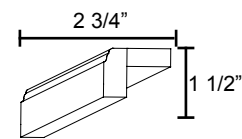

Light Rail

LightRail-4 \$103
LightRail-8 \$156
LightRail-10 \$216

\$0.33 per sq. inch for added height

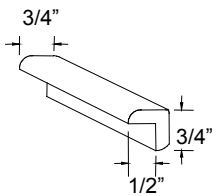

Outside Corner Moulding

OC-MLD-4 \$50
OC-MLD-8 \$78

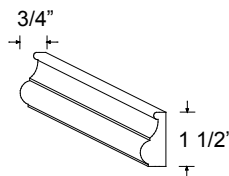

Panel Moulding

PANEL-MLD-4 \$104
PANEL-MLD-8 \$161
PANEL-MLD-10 \$222

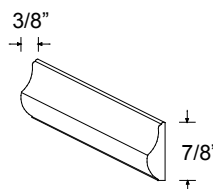

Portsmouth Moulding

PORT-MLD-4 \$71
PORT-MLD-8 \$110
PORT-MLD-10 \$151

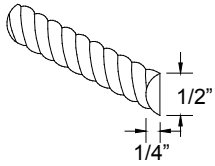

1/2" Rope Moulding

Available in red oak, cherry, and maple only

1/2" ROPE-MLD-8 \$177

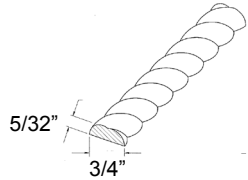

3/4" Rope Moulding

Available in red oak, cherry, and maple only

3/4" ROPE-MLD-8 \$148

1 1/4" Rope Moulding

Available in red oak, cherry, and maple only

1 1/4" ROPE-MLD-8 \$467

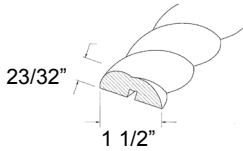

1 1/2" Rope Moulding

Available in red oak, cherry, and maple only

1 1/2" ROPE-MLD-8 \$510

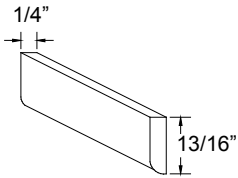

Scribe Moulding

S-MLD-4 \$48
S-MLD-8 \$73
S-MLD-10 \$101

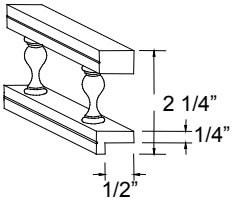

Spindle Rail Moulding

Available in red oak, cherry, and maple only

SR-MLD-4 \$250
SR-MLD-8 \$383

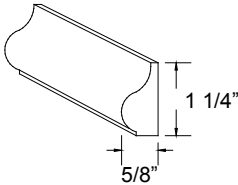

Tear Drop Moulding

TD-MLD-4 \$71
TD-MLD-8 \$110
TD-MLD-10 \$151

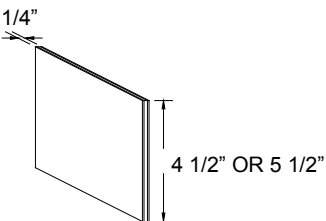

Toekick Moulding

TK-MLD-4 \$50
TK-MLD-8 \$78
TK-5.5 MLD-4 \$56
TK-5.5 MLD-8 \$85

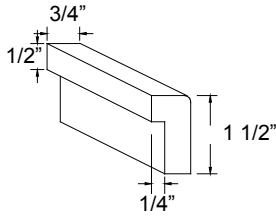

Trim Moulding

T-MLD-4	\$104
T-MLD-8	\$161
T-MLD-10	\$222

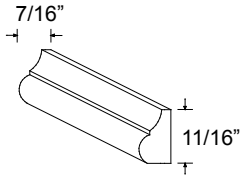

Vermont Moulding

VERMONT-MLD-4	\$71
VERMONT-MLD-8	\$110
VERMONT-MLD-10	\$151

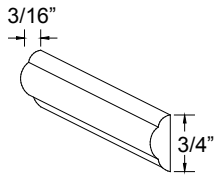

Youngstown Moulding

Y-MLD-4	\$73
Y-MLD-8	\$111
Y-MLD-0	\$151

Rosettes

The above carvings can be applied to extended stiles, fillers, etc.
Exact location must be specified when ordering as an integral carving.

ROSE 3 1/2"	\$144
ROSE 4 3/4"	\$144

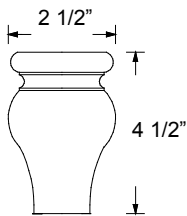
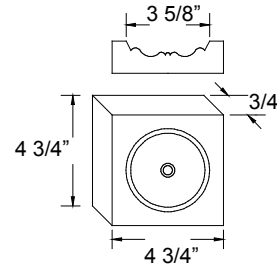
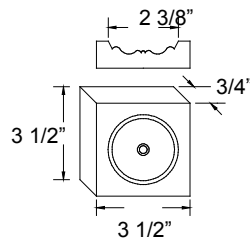

Foot

FOOT	\$302	each
------	-------	------

Available in alder, oak, maple, and cherry only.

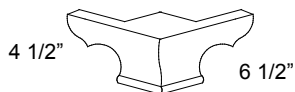

36172 FOOT	\$368	each
------------	-------	------

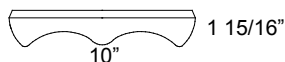

36257 CENTER	\$184	each
--------------	-------	------

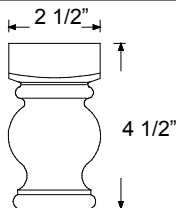

Turned Foot

TURNFT	\$302	each
--------	-------	------

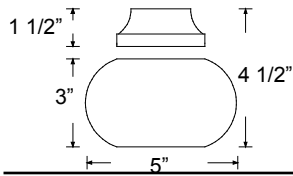

Bun Foot With Optional Top Cap
(used to maintain 4 1/2" toeckick)
(Manufactured in one piece.)

BUNFT	\$144	each
BUNFT w/TOP CAP	\$302	each

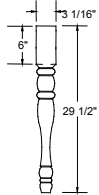

Table Leg

TBL	\$862	each
-----	-------	------



Queen Anne Leg

Available in red oak, cherry, and maple only

QAL 5	\$125	each
QAL 6	\$129	each
QAL 8	\$144	each
QAL 10	\$162	each
QAL 13 1/4	\$302	each
QAL 17 1/4	\$335	each
QAL 20	\$383	each
QAL 24 1/2	\$420	each

Chamfered Back Leg

Chamfered back legs & tapered back legs may be used in place of Queen Anne legs on the back of base and vanity cabinets to achieve a different look.

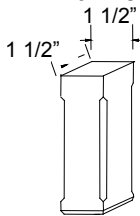

CBL 5	\$125	each
CBL 6	\$129	each
CBL 8	\$144	each
CBL 10	\$158	each
CBL 13 1/4	\$174	each
CBL 17 1/4	\$188	each

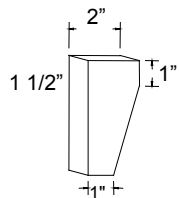

Taper Back Leg

TAP 5	\$125	each
TAP 6	\$129	each
TAP 8	\$144	each

Pyramid Ornaments

SMPYRAMID	\$65	each
LGPYRAMID	\$92	each

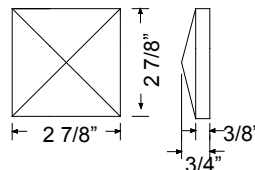
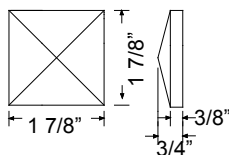

Keystone

Available in any size up to 8" wide.

Send drawing with dimensions if different than 6" wide.

KSTONE \$276 each

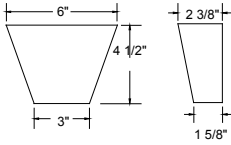

Counter Top Edge Moulding

3/4" x 1 1/2" solid stock counter top edge moulding.

Specify nosing type.

CTE-MLD-4 _____	\$89
CTE-MLD-8 _____	\$175
CTE-MLD-10 _____	\$239

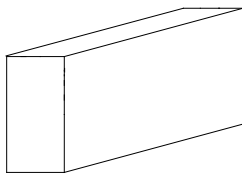

Type B nosing

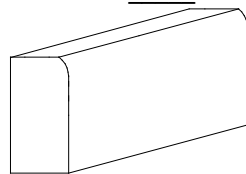

Type B-2 nosing

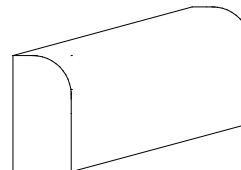

Type C nosing

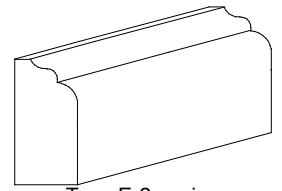

Type E-2 nosing

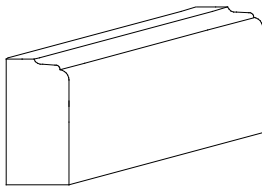

Type H-2 nosing

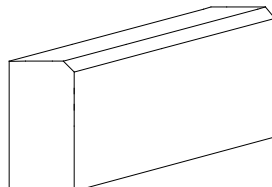

Type J nosing

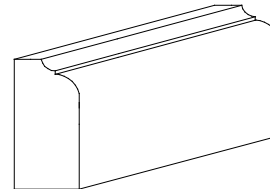

Type J-2 nosing

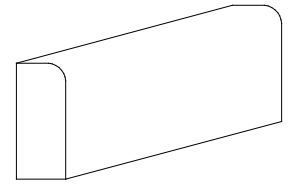

Type L nosing

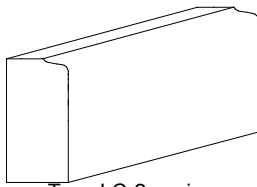

Type LC-2 nosing

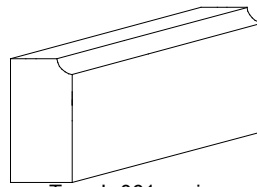

Type L-061 nosing

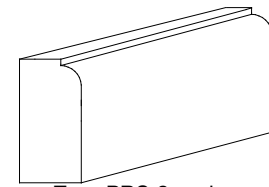

Type PRS-2 nosing

Under Cabinet Moulding

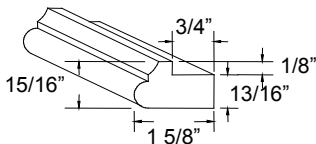

UC-MLD-4	\$73
UC-MLD-8	\$111
UC-MLD-10	\$153

Under Cabinet Moulding - Frameless

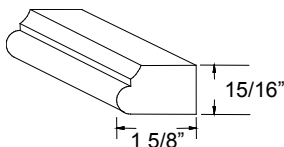

UC-FA-MLD-4	\$73
UC-FA-MLD-8	\$111
UC-FA-MLD-10	\$153

Create A Spindle

Items on this page only available in Red Oak, Maple, Cherry, and Alder. Spindle Moulding comes in 8' lengths.

1 1/2" Spindle Moulding

Specify plain, reeded, or fluted

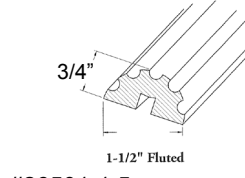
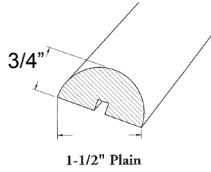

#26501-1.5 _____ \$290

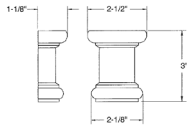
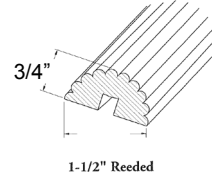

Split Spindle

accommodates 1 1/2" moulding
#26500SS \$40

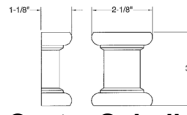

Center Spindle

accommodates 1 1/2" moulding
#26500CS \$40

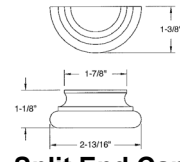

Split End Cap

accommodates 1 1/2" moulding
#26500SEC \$46

2" Spindle Moulding

Specify plain, reeded, or fluted

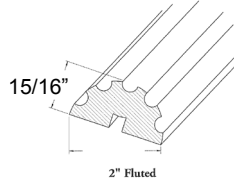
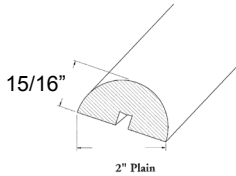

#26501-2 _____ \$395

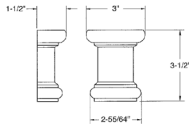
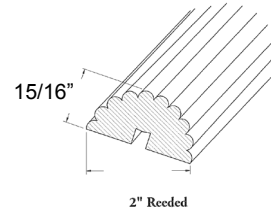

Split Spindle

accommodates 2" moulding
#26501SS \$46

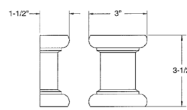

Center Spindle

accommodates 2" moulding
#26501CS \$46

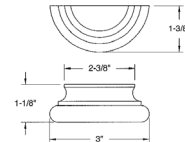

Split End Cap

accommodates 2" moulding
#26501SEC \$50

End Blocks

End blocks can be ordered 6" high to 12" high (same price) Please specify when ordering.

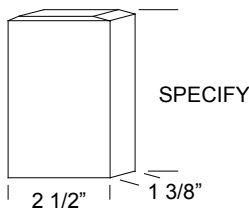

26500EB \$59

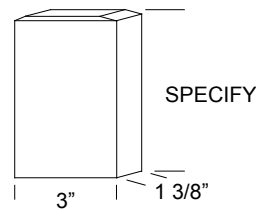

26501EB \$79



Square Post

4" x 4" or 6" x 6" square post made out of 3/4" solid wood. Specify height required. Maximum length 96".

You must order lapped when a decorative edge, chamfer, etc. is required.

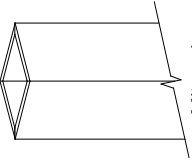
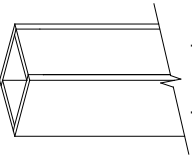

SQPS Lapped 4 x 4	\$90	per linear ft
SQPS Lapped 6 x 6	\$121	per linear ft
SQPS Miter 4 x 4	\$116	per linear ft
SQPS Miter 6 x 6	\$148	per linear ft

Split Options For Spindles

Top Views

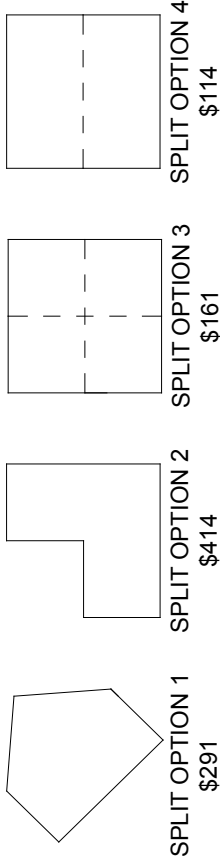

SPLIT OPTION 1 \$291

SPLIT OPTION 2 \$414

SPLIT OPTION 3 \$161

SPLIT OPTION 4 \$114

Spindles

All spindles 34 1/2" height. For larger heights, contact factory for price quote. You may order any size spindle between dimensions shown for the same price. We can manufacture other style spindles. Fax detail drawing for price quote.

Specify width x height of spindles,

i.e. COL-FLU 2 7/8" x 34 1/2"\$882.00

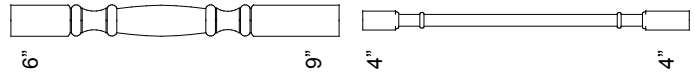

SPIN 1
SPIN1 4"-5 1/2" \$1,672
SPIN 5 3/4"-7" \$2,495

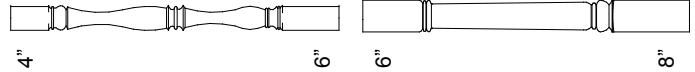

SPIN 4
SPIN4 1 1/2"-1 3/4" \$582
SPIN4 2"-3 1/2" \$952
SPIN4 4"-5 1/2" \$1,672
SPIN4 5 3/4"-7" \$2,495

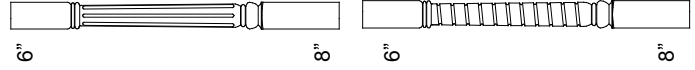

COLONIAL
COL 1 1/4"-1 3/4" \$582
COL 2"-3 1/2" \$952
COL 4"-5 1/2" \$1,672
COL 5 3/4"-7" \$2,495

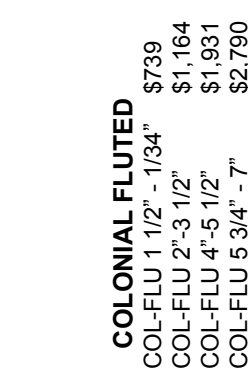

COLONIAL FLUTED
COL-FLU 1 1/2" - 1/34" \$739
COL-FLU 2"-3 1/2" \$1,164
COL-FLU 4"-5 1/2" \$1,931
COL-FLU 5 3/4" - 7" \$2,790

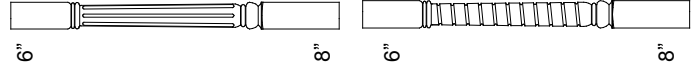

COLONIAL SPIRAL
COL-SPI 1/2"-1 3/4" \$1,257
COL-SPI 2"-3 1/2" \$1,754
COL-SPI 4"-5 1/2" \$2,601
COL-SPI 5 3/4"-7" \$3,590

Conestoga Spindles

The following turnings are only available in the woods and sizes shown. Check each turning for split options available. See Section N SPLIT OPTIONS for split option pricing.

Arts & Crafts Post	Basket Weave	British Spiral 3 1/2"	British Spiral 4 1/4"	Century Plain 3 1/2"
Maple Cherry	Red Oak Maple Cherry	Alder Red Oak Maple Cherry	Alder Red Oak Maple Cherry	Alder Red Oak Maple Cherry
None	4	2, 4	2, 4	2, 4
Split Options Available				
Specify	ARTS	BARLEY SPIRAL	BASKET WEAVE	BRITISH SPIRAL 3.5
Price	\$1010	\$858	\$1597	\$1188
				CENTURY PLAIN 3.5
				\$693

Conestoga Spindles, cont.

		Century Plain 4 1/4"	Alder Red Oak Maple Cherry	2, 4	CENTURY PLAIN 4.25	\$1010
		Century Plain 5"	Alder Red Oak Maple Cherry	2, 4	CENTURY PLAIN 5	\$858
		Country French Reeded 3 1/2"	Alder Red Oak Maple Cherry	4	COUNTRY FRENCH REED 3.25	\$805
		Country French Reeded 4 1/4"	Alder Red Oak Maple Cherry	4	COUNTRY FRENCH REED 4.25	\$1102
		Country French Plain 3 1/2"	Alder Red Oak Maple Cherry	2, 4	COUNTRY FRENCH PLAIN 3.5	\$726
		Country French Plain 4 1/4"	Alder Red Oak Maple Cherry	2, 4	COUNTRY FRENCH PLAIN 4.25	\$1010
Species			Alder Red Oak Maple Cherry			
Split Options Available				2, 4		
Specify						
Price						

Conestoga Spindles, cont.

		Country Kitchen Fluted 3 1/2"			Country Kitchen Plain 3 1/2" - 35 1/4"		Country Kitchen Plain 3 1/2" - 42"		Country Kitchen Twist 3 1/2" - 35 1/4"		Countryside Plain 3 1/2"
Species	Alder Red Oak Maple Cherry	Alder Red Oak Maple Cherry	Alder Red Oak Maple Cherry	Alder Red Oak Maple Cherry	Alder Red Oak Maple Cherry	Alder Red Oak Maple Cherry	Alder Red Oak Maple Cherry	Alder Red Oak Maple Cherry	Alder Red Oak Maple Cherry	Alder Red Oak Maple Cherry	
Split Options Available	4	2, 4	2, 4	2, 4	2, 4	2, 4	2, 4	2, 4	2, 4	2, 4	
Specify	COUNTRY KIT FLUT 3.5	COUNTRY KIT PLAIN 3.5-29.25	COUNTRY KIT PLAIN 3.5-32.25	COUNTRY KIT PLAIN 3.5-42	COUNTRY KIT TWIST 3.5-35.25	COUNTRY KIT PLAIN 3.5-42	COUNTRY KIT TWIST 3.5-35.25	COUNTRY KIT PLAIN 3.5			
Price	\$779	\$561	\$700	\$878	\$779	\$832					

Conestoga Spindles, cont.

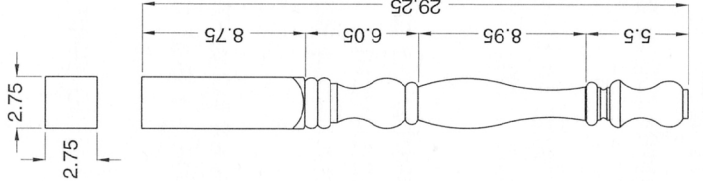
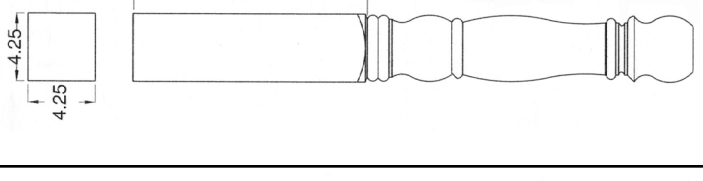
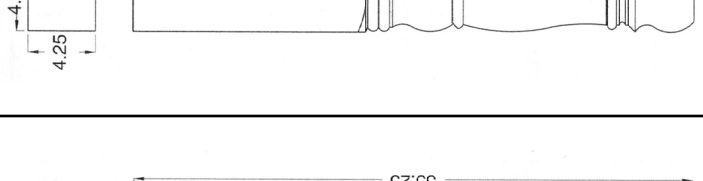
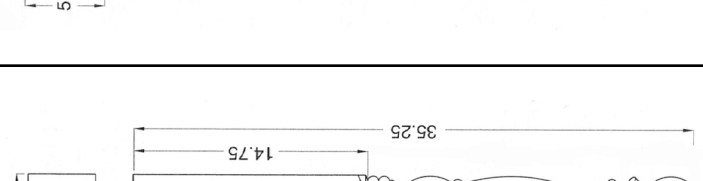
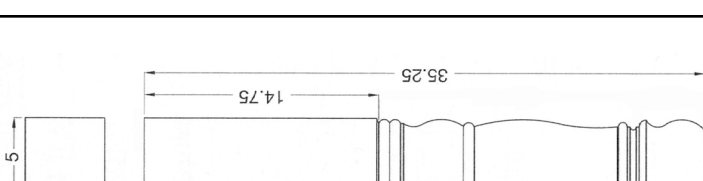
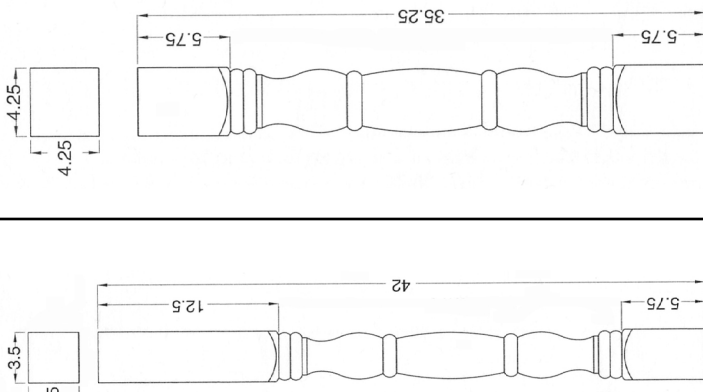
							<p>English Country 2 3/4"</p>	<p>English Country 3 1/2"</p>	<p>English Country 4 1/4" - 35 1/4"</p>	<p>English Country 5" - 35 1/4"</p>	<p>English Country Double Square 3 1/2" - 42"</p>	<p>English Country Double Square 4 1/4" - 35 1/4"</p>	<p>Alder Red Oak Maple Cherry</p> <p>Alder Red Oak Maple Cherry</p> <p>Alder Red Oak Maple Cherry</p> <p>Alder Red Oak Maple Cherry</p> <p>Alder Red Oak Maple Cherry</p> <p>Alder Red Oak Maple Cherry</p> <p>2, 4</p> <p>2, 4</p> <p>2, 4</p> <p>2, 4</p> <p>2, 4</p> <p>2, 4</p> <p>ENG COUNTRY 2.75</p> <p>ENG COUNTRY 3.5</p> <p>ENG COUNTRY 4.25-35.25</p> <p>ENG COUNTRY 5-35.25</p> <p>ENG COUNTRY DBLSQ 3.5-42</p> <p>ENG COUNTRY DBLSQ 4.25-35.25</p> <p>\$422</p> <p>\$693</p> <p>\$1010</p> <p>\$1287</p> <p>\$1096</p> <p>\$1049</p>
<p>Species</p>													
<p>Split Options Available</p>													
<p>Specify</p>													
<p>Price</p>													

Conestoga Spindles, cont.

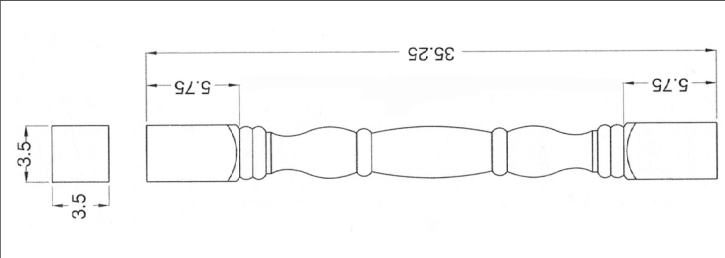
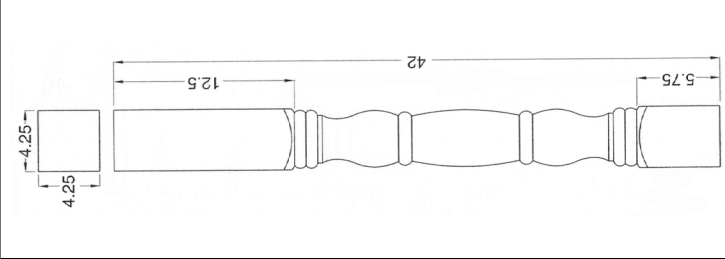
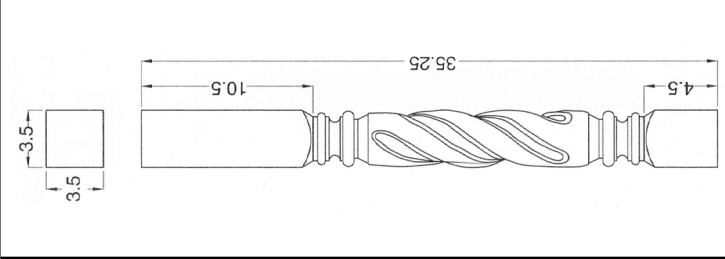
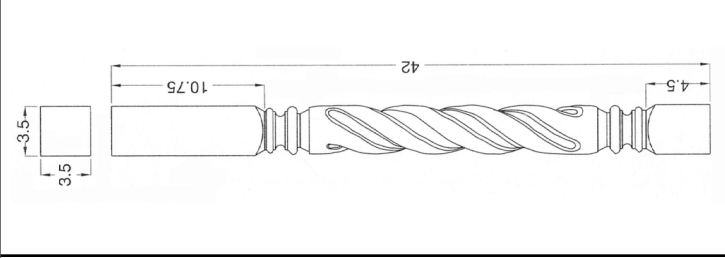
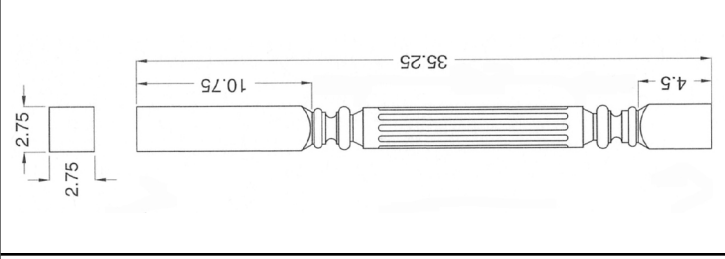
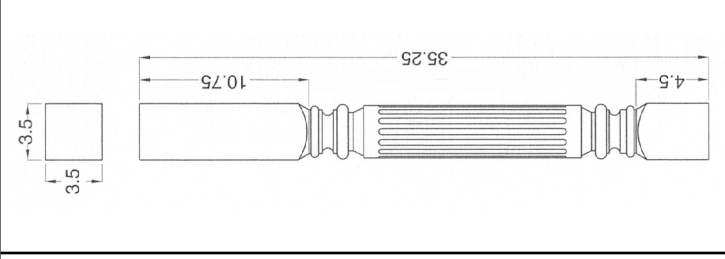
		English Country Double Square 3 1/2" - 35 1/4"	Alder Red Oak Maple Cherry	2, 4	\$733	ENG COUNTRY DBLSQ 3.5-36.25
		English Country Double Square 4 1/4" - 42	Alder Red Oak Maple Cherry	2, 4	\$1406	ENG COUNTRY DBLSQ 4.25-42
		Greco Roman Barley Twist 3 1/2" - 35 1/4"	Alder Red Oak Maple Cherry	2, 4	\$917	ROMAN TWIST 3.5-32.25
		Greco Roman Barley Twist 3 1/2" - 42"	Alder Red Oak Maple Cherry	2, 4	\$1287	ROMAN TWIST 3.5-42
		Greco Roman Fluted 2 3/4" - 35 1/4"	Alder Red Oak Maple Cherry	4	\$521	ROMAN FLUTED 2.75-32.25
		Greco Roman Fluted 3 1/2" - 35 1/4"	Alder Red Oak Maple Cherry	4	\$792	ROMAN FLUTED 3.5-32.25
Species						
Split Options Available						
Specify						
Price						

Conestoga Spindles, cont.

		Greco Roman Fluted 4 1/4" - 35 1/4"	Alder Red Oak Maple Cherry	4	ROMAN FLUTED 4.25-32.25	\$1122
		Greco Roman Fluted 5" - 35 1/4"	Alder Red Oak Maple Cherry	4	ROMAN FLUTED 5-32.25	\$1373
		Greco Roman Pillar Fluted	Alder Red Oak Maple Cherry	4	ROMAN PILLAR FLUTED	\$785
		Greco Roman Pillar Plain	Alder Red Oak Maple Cherry	2, 4	ROMAN PILLAR PLAIN	\$726
		Greco Roman Pillar Twist	Alder Red Oak Maple Cherry	2, 4	ROMAN PILLAR TWIST	\$845
		Greco Roman Plain 3 1/2" - 35 1/4"	Alder Red Oak Maple Cherry	2, 4	ROMAN PLAIN 3.5-35.25	\$726
Species			Alder Red Oak Maple Cherry			
Split Options Available				4		
Specify					ROMAN FLUTED 4.25-32.25	
Price						\$1122

Conestoga Spindles, cont.

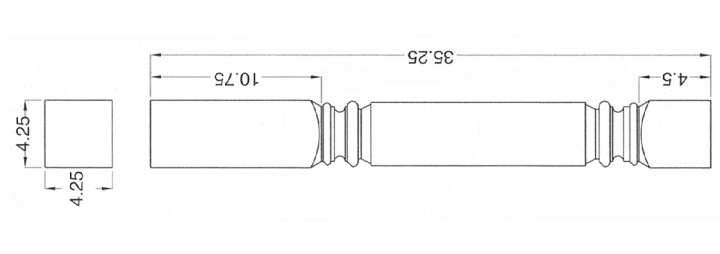
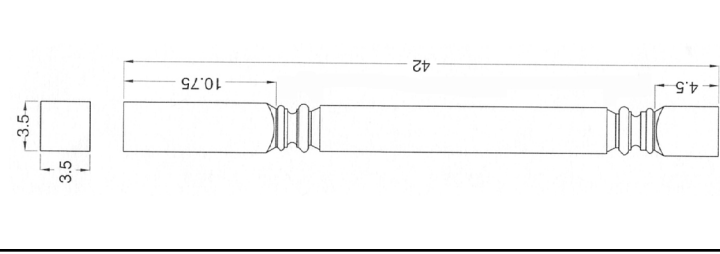
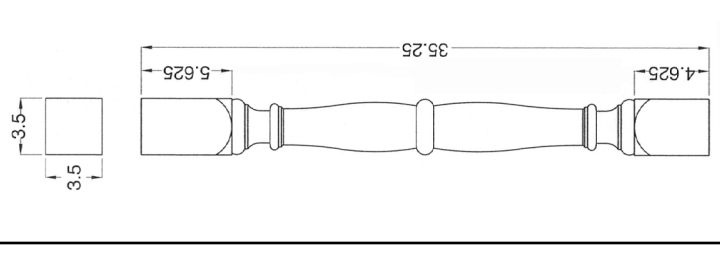
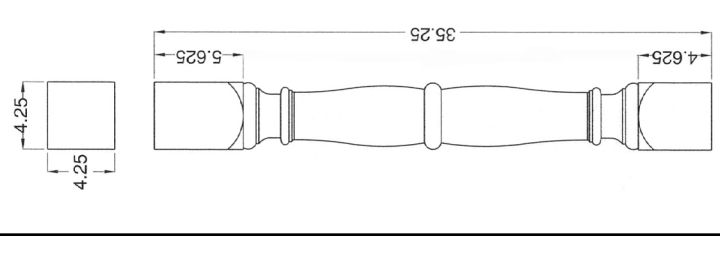
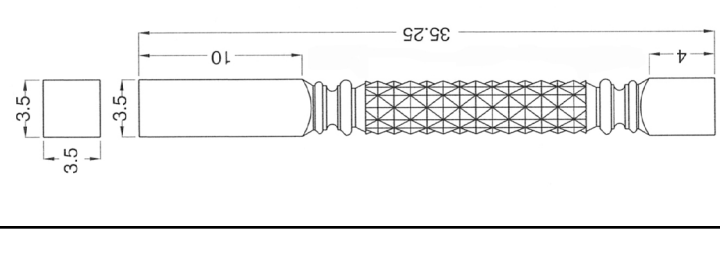
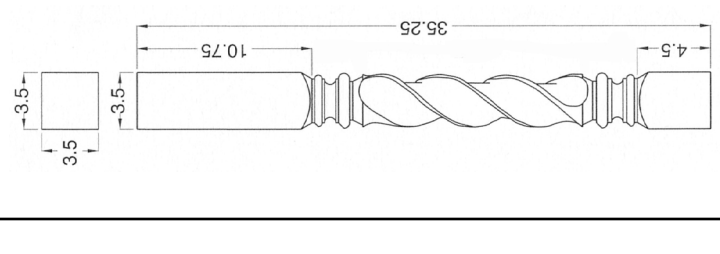
						
	Greco Roman Plain 4 1/4\" - 35 1/4\"	Greco Roman Plain 3 1/2\" - 42\"	Philmont 3 1/2\" - 35 1/4\"	Philmont 4 1/4\" - 35 1/4\"	Pineapple 4 1/4\" - 35 1/4\"	Ribbon Spiral 3 1/2\" - 35 1/4\"
Species	Alder Red Oak Maple Cherry	Alder Red Oak Maple Cherry	Alder Red Oak Maple Cherry	Alder Red Oak Maple Cherry	Red Oak Maple Cherry	Alder Red Oak Maple Cherry
Split Options Available	2, 4	2, 4	2, 4	2, 4	4	2, 4
Specify	ROMAN PLAIN 4.25-35.25	ROMAN PLAIN 3.5-42	PHILMONT 3.5-35.25	PHILMONT 4.25-35.25	PINEAPPLE 3.5-35.25	RIBBON SPIRAL 3.5-35.25
Price	\$1049	\$1096	\$733	\$1049	\$950	\$917